

Andrew Derry

Pg. 81

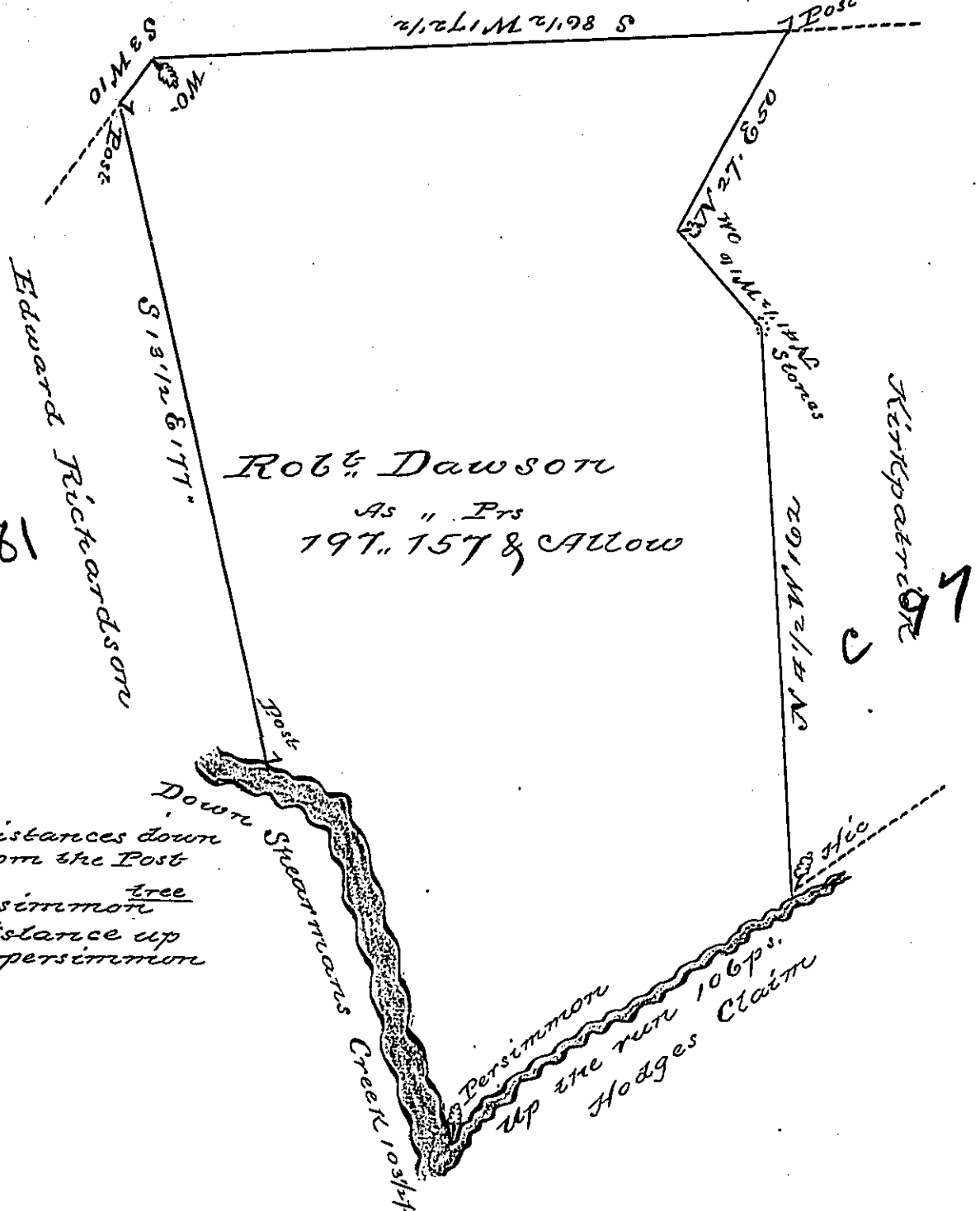

The Courses and Distances down
 Steamboat Creek from the Post
 S 80 E 10
 S 22 E 93 1/2 to a persimmon tree
 The Course and distance up
 the run, from the persimmon
 to the track
 N 55 E 106

The Draught of a Tract of Land Situate in
 the Township Cumberland County Contain-
 ing One Hundred and Ninety Seven Acres
 and One Hundred and Fifty Seven Perches
 and Allowance of Six 1/2 C. for roads &c. Sur-
 veyd May the Eighteenth 1803 on a Warrant
 of Two Hundred Acres Granted to Robt Dawson
 Dated 29th October 1784

Wm Ramsey
 To Saml Cochran Esquire } D. J.
 Surveyor Genl of Pennsylv. a }

IN TESTIMONY that the above is a copy of the original remaining on file in
 the Department of Internal Affairs of Pennsylvania, made
 conformably to an Act of Assembly approved the 16th day of
 February, 1833, I have hereunto set my Hand and caused
 the Seal of said Department to be affixed at Harrisburg,
 this sixth day of September 1898

James W. Latta
 Secretary of Internal Affairs.